

Type: Waveguide Isolator series
Model no.: YXWI100-12.7
Features

1. Frequency range is from 8.2GHz to 12.5GHz
2. Reliable performance and competitive cost guaranteed by high quality materials and optimized design.
3. Customized Designs are available per request

Electronic parameters at room temperature (25°C aro.)

P/N.	Frequency Range	Relative Bandwidth	Insertion Loss (dB.Max)	Isolation (dB.Min)	VSWR (Max)	Operating Temp. (°C)	Forward Power (W)	Reverse Power (W)	Direction	Connector
	(GHz)									
YXWI100-12.7	8.20-12.5	3% (310MHz)	0.3	25	1.20	-40 ~ +85	-	-	-	WR90

Mechanical Dimensions (unit: mm)

Pls provide below information when inquiring

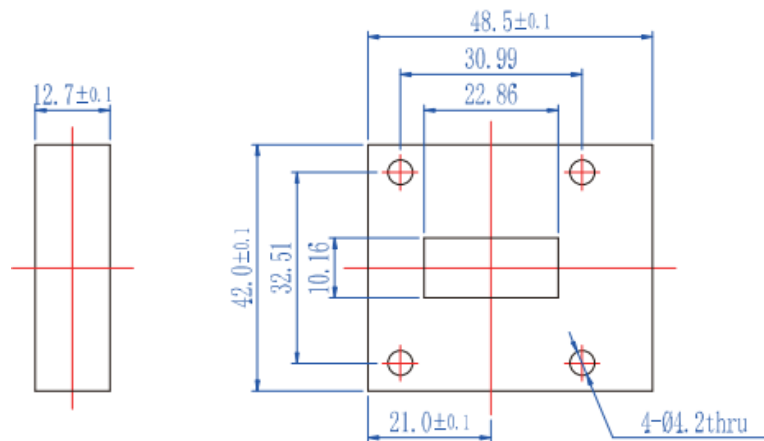

The specific working frequency range

- 1- Required specification on IL, Isolation and VSWR
- 2- Power handling
- 3- Connector type
- 4- Other specific requirement details